

REV	DC. CT. NUMBER	DESCRIPTION	DATE
V0		首次发行	2013.02.28

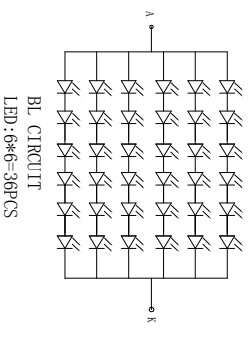
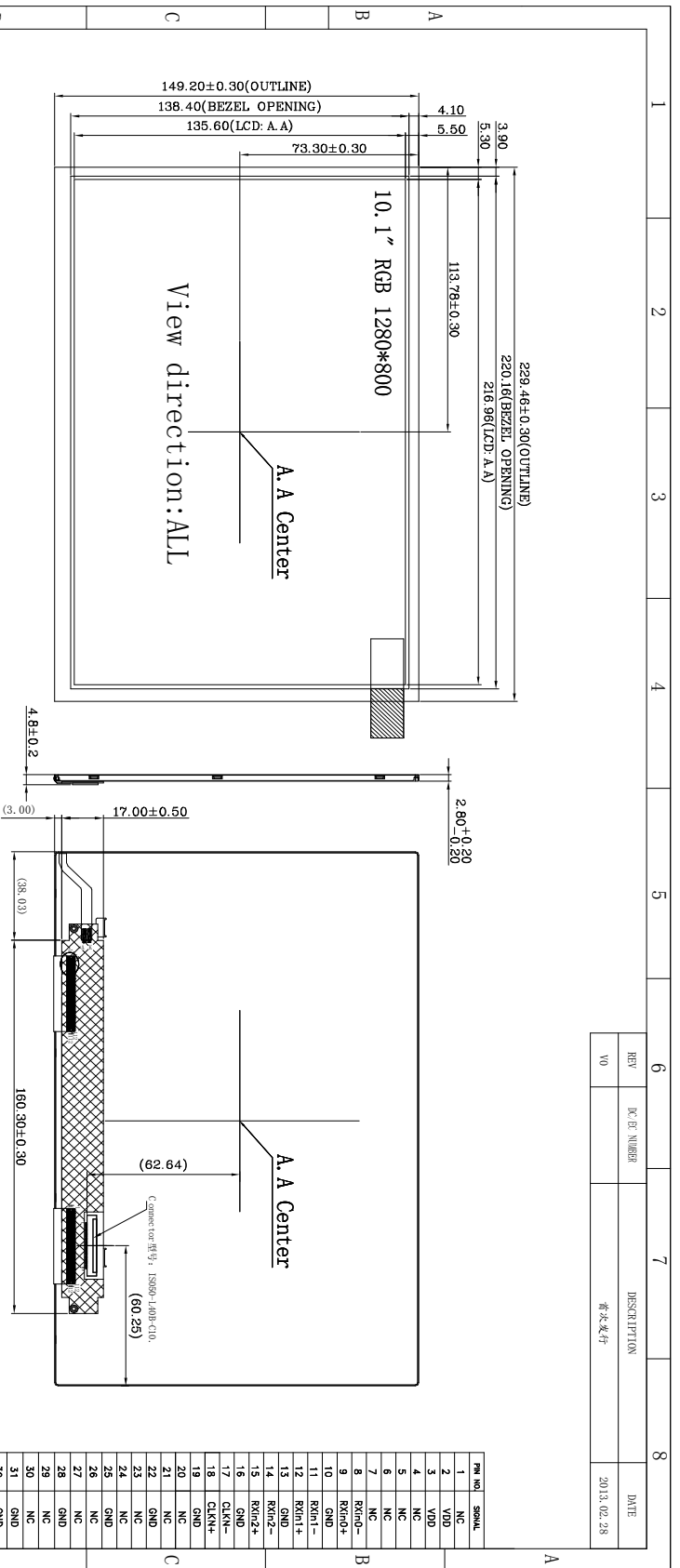

- NOTES:
1. Display type: 10.1" 262K TFT-LCD, Transmissive, Normally Black;
 2. Operating Temperature: 0° C~50° C;
 3. Storage Temperature: -20° C~60° C;
 4. General Tolerance: ±0.20;
 5. Connector 型号: IS050-140B-C10.
 6. Brightness: 200cd/m²(min), 250cd/m²(TYP).

<input type="checkbox"/>	Critical Dimension	<input checked="" type="checkbox"/>	Spec Dimension	UNIT	SCALE	3rd ANGLE	WORD NAME	PROJ. NUMBER	DATE
<input type="checkbox"/>	APPROVED	<input checked="" type="checkbox"/>	CHECKED	mm	1:1	第三角投影	TTO13W0303H	2013.03.14	
<input type="checkbox"/>	DESIGNED								

DIMENSION		GENERAL LINEAR TOLERANCE			START	END
0-1	0.08	1	0.2	0.2		
1-4	0.1	2	0.2	0.2		
4-14	0.15	3	0.2	0.2		
14-50	0.2	4	0.2	0.2		
50-160	0.3	5	0.2	0.2		
160-630	0.4	6	0.2	0.2		
630-1000	0.5	7	0.2	0.2		
		8	0.2	0.2		

1 2 3 4 5 6 7 8